

WALL MOUNTS





1LG

The Universal One-Legged Mount may be the one and only mount that can be installed on any part of any building. This mount is designed for virtually all types of antennas – home, TV, MMDS, DBS and more. The mount has a 1-1/4" mounting pipe and includes lag screws for installation. The mount is galvanized for corrosion protection and goes together quickly. The mount is easily shipped via UPS.

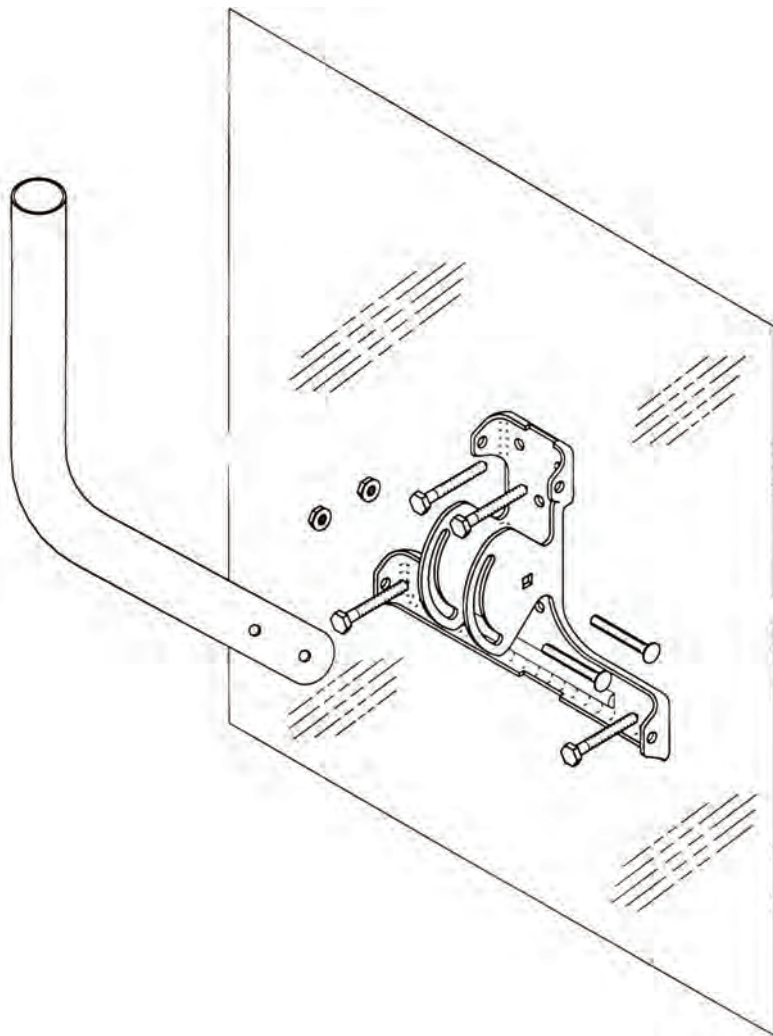

1LG Contains the Following:

FH85	Formed Bracket (1)
FH86	1-1/4" O.D. Tube (1)
S180091	1/4" x 1-3/4" Carriage Bolt (2)
220369	1/4" Flange Nut (2)
220352	1/4" x 2" Lag Screw (4)

Notes:

1. One legged mount can be installed on a flat or pitched roof, wood or masonry wall or eave (gable end).
2. All antenna installations should be grounded by the installer to meet all applicable codes.
3. To insure safety, no installation on roof or wall, should be attempted without a local professional structural analysis.
4. Inspect mount and antenna installation every 6 months (or after every storm) for tightness.
5. It is the installer's responsibility to verify that their installation is adequate to withstand all loads imposed by this mount and antenna.
6. Local zoning and/or building codes and insurance companies may require architect or structural engineer approval prior to installation.
7. Mounting tube is 1-1/4" O.D.
8. Antenna not to exceed 2 square feet of effective projected area.

PWM

The ROHN Pole Wall Mount (PWM) is designed to support most Satellite, PCS, Cellular, and Microwave antennas. The PWM allows you to vary the mounting pipe length and diameter, accepting up to 5-1/2" OD pipe. The PWM is hot-dip galvanized after fabrication, and can easily be shipped UPS.

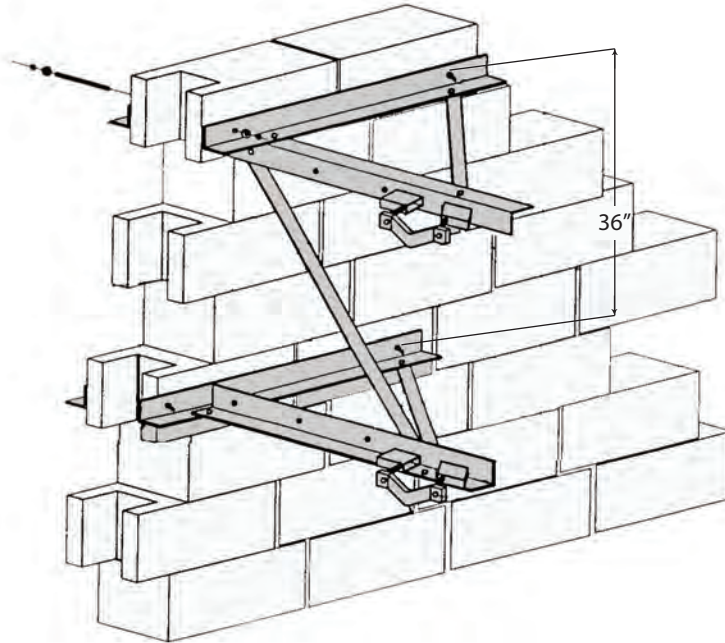

Notes:

1. It is the purchaser's responsibility to verify that their installation is adequate to withstand all loads imposed by this mount and antenna.
2. All antenna installations should be grounded, by installer, to meet all applicable codes.
3. Inspect the mount and antenna installation every 6 months.
4. Optional hardware mounting kit may be purchased separately from ROHN (P/N HMK18M).
5. Optional inside mounting angles may be purchased separately from ROHN (P/N FY77).
6. Assembly shown does not include the pole, which may be purchased separately from ROHN.
7. If the pole is to be installed plumb, the lower mounting angle should be moved 2" more to the left, than the top mounting angle, prior to attaching the mount to the building.
8. If the pole is mounted 15-3/4" from the building, use the extra 1/2" x 1-1/2" bolt assembly to fasten the diagonal brace to the lower mounting angle.
9. Pal nuts are included with the bolt assemblies and are to be installed with the concave surface against the standard nut.
10. To obtain maximum capacity of the PWM, bolts should be tightened in accordance with AISC recommendations.
11. All parts are hot-dip galvanized after fabrication.
12. Angles must be positioned as shown.



WM212 / WM4 - 24 SINGLE & DOUBLE BRACKET

ROHN Wall Mounts can be used on masonry, wood, metal, and other types of walls. The Wall Mounts are versatile, coming in a variety of stand off lengths and supporting up to 2-3/8" O.D. masts. The mounts are available as single brackets or double brackets. Masts are held in place with a unique "Anti-Twist" locking clamp. Galvanized for durability, these Wall Mounts are UPS shippable.

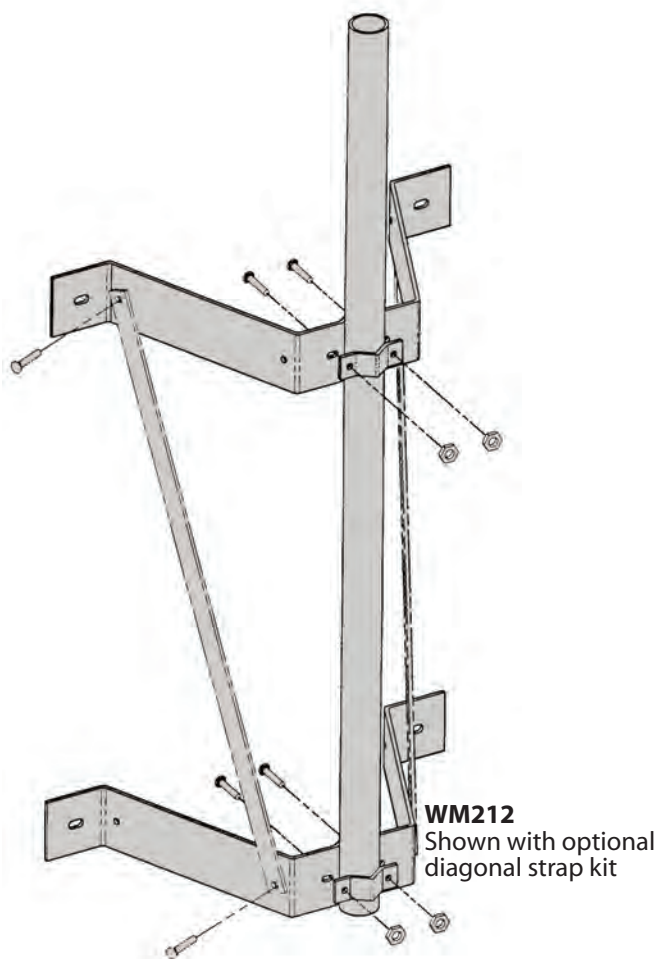

WM212
Shown with optional
diagonal strap kit

Double:

WM212	2" Pipe x 72" long Wall Mount Kit
WMB12A	Optional Diagonal Strap Kit
HMK18M	Optional Mounting Kit for WM212

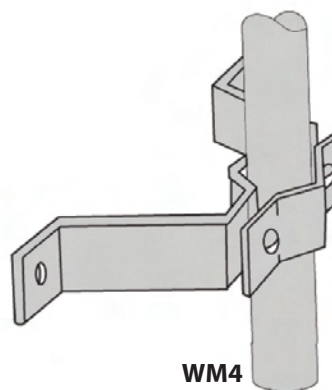

WM4

Accepts round members 7/8" - 2 1/2" O.D.

Single:

WM4	4" clearance
WM6S	6" clearance
WM8S	8" clearance
WM12S	12" clearance
WM18S	18" clearance
WM24S	24" clearance

Double:

WM8D	8" clearance
WM12D	12" clearance
WM18D	18" clearance
WM24D	24" clearance

Notes:

1. It is the purchaser's responsibility to verify that their installation and building system will withstand all loads imposed by their antenna system.
2. Antenna installations should be grounded by the installer to meet all applicable codes.
3. Inspect the mount and antenna every 6 months.
4. Optional ROHN hardware mounting kits for WM212 may be purchased separately from ROHN (P/N HMK18M).
5. All parts are hot-dip galvanized after fabrication
6. Pal nuts are provided with all bolt assemblies.
7. Local zoning and/or building codes and insurance companies may require an architect or structural engineer approval prior to installation.

STEEL TUBING

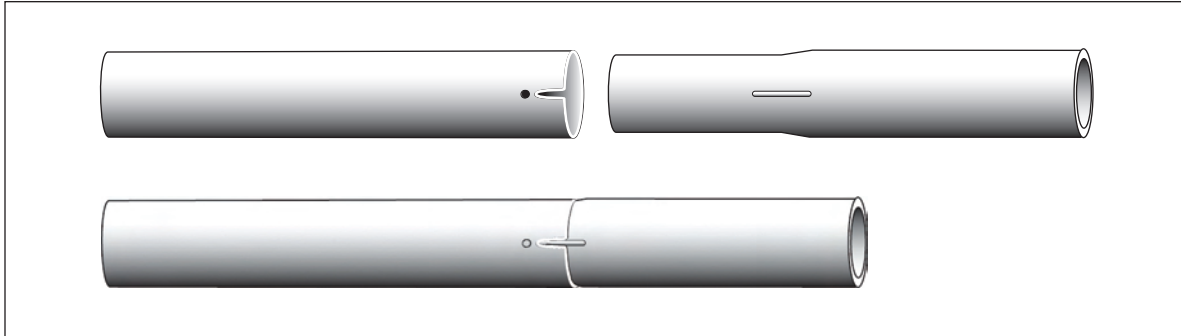

ROHN offers both swaged and expanded tubing, commonly used with our roof and wall mounts.

Swaged - This tubing, with locking joint is available in 16 GA. When tubing is swaged, the metal is compressed and made thicker so the joint is stronger than the original material. Swaging also eliminates the "joint bulge" common with expanded tubing.

Expanded - A tube with an expanded end along with a tube with a plain end allows the stacking of tubes.

ROHN tubing is offered in two types of finishes, hot-dip galvanized and pre-galvanized. ROHN's hot-dip galvanized tubing is fabricated from high strength steel, then immersed in molten zinc giving all surfaces, including the interior, an even coating of zinc for maximum corrosion protection. There are no seams, holes or edges left uncoated. Pre-galvanized tubing is made from a coil of steel which is galvanized at the steel mill, cut into strips, and then formed into a piece of tubing. Where the tubing is welded, zinc is sprayed over the weld to give it protection at that point. It does, however, have a slightly uncoated seam on the inside and ends.

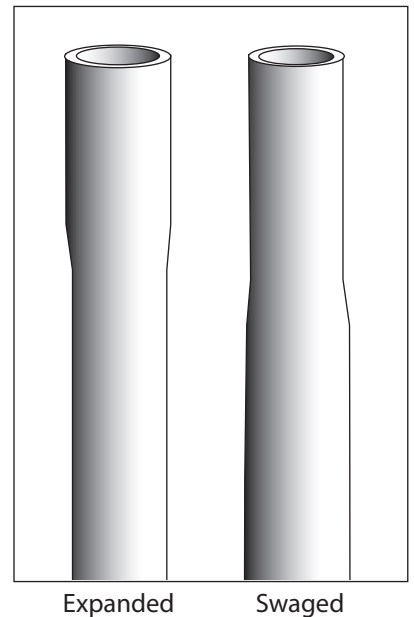

TUBING SPECIFICATIONS

Tubing Part No.	End Type	Description	Finish
R-160505GHS	Swaged	Tube 1-1/4" OD x 16 GA x 5' SE HDG	Hot-Dip Galvanized
R-160505PHS	Swaged	Tube 1-1/4" OD x 16 GA x 5' PG SE	Pre-Galvanized
R-160506PLX	Expanded	Tube 1-1/2" OD x 16 GA x 5' DG EX	Pre-Galvanized
R-161005GHS	Swaged	Tube 1-1/4" OD x 16 GA x 10' HDG SW	Hot-Dip Galvanized
R-161005PHS	Swaged	Tube 1-1/4" OD x 16 GA x 10' PG SW	Pre-Galvanized