

User Manual

Wireless Inspection Camera with Color LCD Monitor

Model No.: 8802AJ

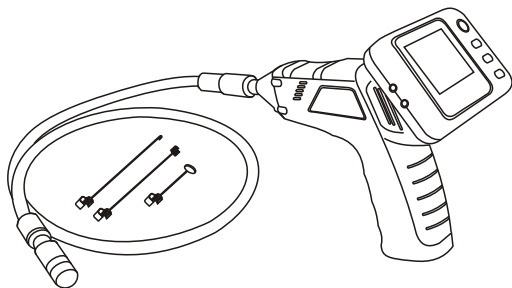

Version No.: 1.1

Please read this user Manual carefully before using this product!

CONTENTS

WELCOME	1
PACKING LIST	1
STRUCTURE	2
INSTALLATION	3
GENERAL SAFETY INFORMATION	6
OPERATION	6
SPECIFICATIONS	8
CAUTIONS	9
FCC INFORMATION	Back cover

* 8802AJ means GB8802(camera) + GB7802(monitor)

WELCOME

Thanks you for choosing our inspection video camera and color LCD monitor. Please read the operation guide carefully before using this product.

The product is designed as a remote inspection device. It can be used to look into tight spots and beam back real-time video to monitor. Typical applications might include HVAC inspection, automotive inspection, cable routing, automotive/boat/aircraft inspection, etc.

PACKING LIST

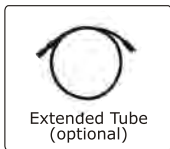
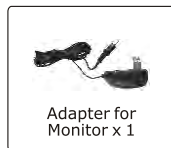

STRUCTURE

Camera

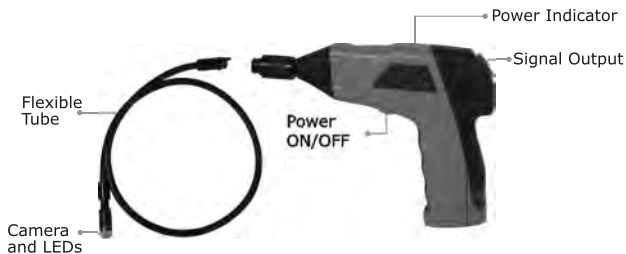

Monitor



INSTALLATION

Please install the batteries, tube first before using the product, and choose the accessory according to actual situation. Steps of installation as following:

To Install Batteries

1. Using a screwdriver, remove screw and cover.

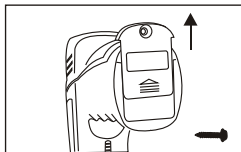
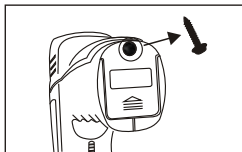

2. Remove battery compartment and insert four new AA batteries into the proper slots in the battery compartment. Proper battery orientation is indicated on the battery compartment.

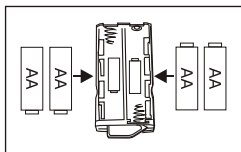
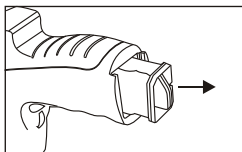

3. Reinstall battery compartment and battery cover and screw as before.

NOTE! Dry your hands before installation or replacing batteries.

To Install The Camera With Flexible Tube

Connect the camera with tube to the body, make sure the keyed ends are properly aligned. Once they are aligned, finger tighten the knurled knob to hold the connection in place.

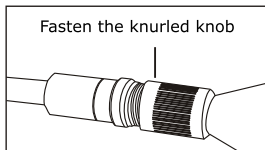
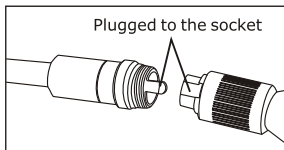

To Install Accessory

The three included accessories, (mirror, hook and magnet) all attached to the camera by the same way. To install as following:

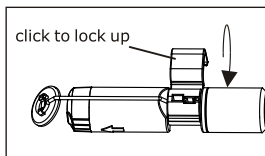
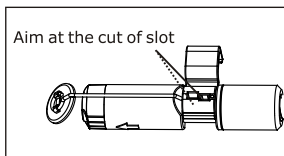

Make sure the stem placed at side face from the arrow mark, and finger tighten to secure the accessories in place.

To Install Monitor for Wired Use

The product also supports wired use by connect the monitor to camera.

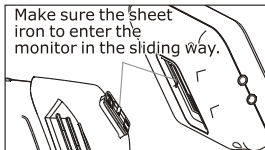
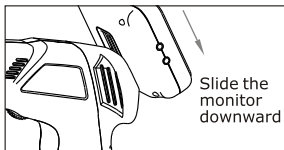
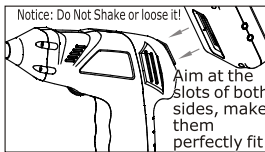
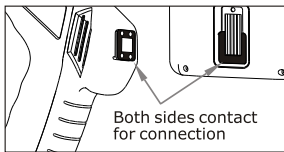

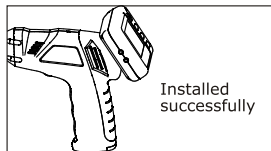
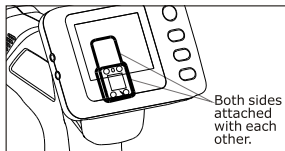

To Connect Monitor Power

Plug the connect cable into power socket of monitor, and plug the end of connect cable into adapter, then connect the adapter to 8V~24V power, the power indicator will lights on red, which indicates being charging.

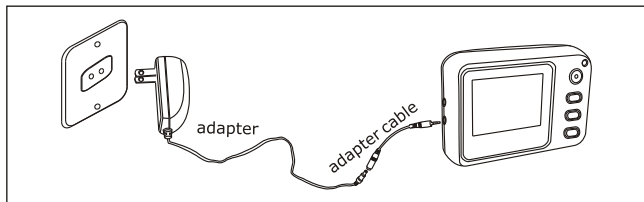

The built-in Li-battery will be charged after the adapter is plugged in, and the Red indicator lights up during charging and will turn off after a full charge.

Video Input

Insert the video cable into the VIDEO IN socket of monitor. Insert the other end of the cable into the VIDEO OUT jack of a wired camera. The Monitor will receive a high quality video.

Video Output

Insert the video cable into the VIDEO OUT socket of monitor. Insert the other end of the cable into the VIDEO IN jack of a TV or another monitor. The LCD Monitor will output a high quality video.

GENERAL SAFETY INFORMATION

WARNING! Read and understand all instructions. Failure to follow all instructions listed below may result in electric shock, fire and/or serious personal injury.

SAVE THESE INSTRUCTIONS!

- ※ **Prevent object and liquid entry.** Never spill liquid of any kind on the video display unit. Liquid increases the risk of electrical shock and damage to the product.
- ※ **The unit is not shock-resistant.** Do not use it as a hammer or drop it.
- ※ **Do not immerse the camera and monitor in water.** Store in a dry place. Such measures reduce the risk of electric shock and damage. The imager head and the cable are water resistant when the unit is fully assembled, but the monitor and camera is not.
- ※ **Do not use the camera if condensation forms inside the lens.** Let the water evaporate before using again.

Operation

1. Roll the ON/OFF switch to turn ON the camera, and the power indicator will lights, The switch then acts as a dimmer for the twin LEDs that surround the camera on the imager head and provide lighting.

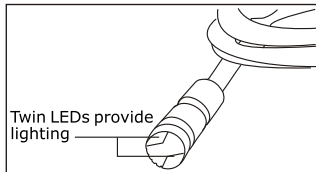
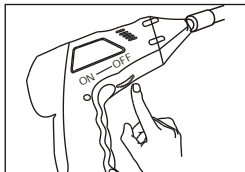

- Slide the ON/OFF switch to ON position, and power indicator will lights on green, the picture display on LCD. Adjust brightness, contrast, orientation, and roll the ON/OFF switch of the camera for better image effect.

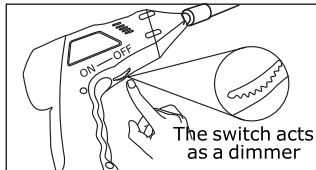
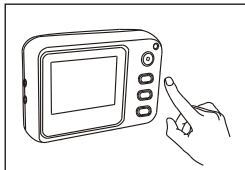

- When in use, the tube should easily maneuver itself into position going forward.

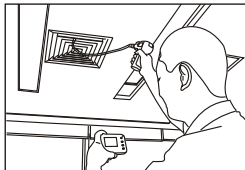

wireless

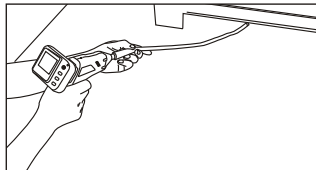

wired

TIP! The flexible tube can be bent into a certain shape. This may help you explore the tube into narrow areas.

- The accessories of Handhold Inspection Camera can be used to retrieve small items like dropped rings or screws.

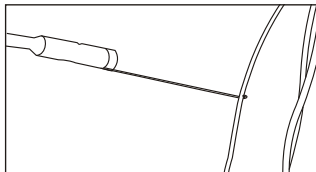

SPECIFICATIONS

	Mode No.	GB8802
camera	Imaging Sensor	CMOS
	Total Pixels	704×576 (PAL); 712×486(NTSC)
	Horizontal View Angle	50 degree
	Transmission Frequency	2468MHz
	Minimum Illumination	0 Lux
	Modulation Type	FM
	Bandwidth	18MHz
	Power Supply	4 x AA batteries
	Unobstructed Effective Range	10m
	Waterproof Capacity	IP67(only for imager head)
	Dimensions(W×D×H)	186 x 145 x 41(mm) (Exclude Flexible Tube)
	Weight(about)	530g
monitor	Mode No.	GB7802
	LCD Screen Type	2.36" TFT-LCD
	Effective Pixels	480 × 240
	Video System	PAL/NTSC
	Transmission Frequency	2468MHz
	Exterior Supply Voltage	8V-24V _{DC}
	Consumption Current (Max.)	490mA
	Video Output Level	0.9-1.3V _{p-p} @75ohm
	Receiving Sensitivity	≤ -85dBm
	Dimensions(W x D x H)	100 x 70 x 30(mm)
	Weight(About)	140g
	Operating Temperature	-10°C~+50°C/+14°F~+122°F
Operating Humidity(Max.)	15~85%RH	

- * Actual transmission range may vary according to the weather, location, interference and building construction.
- * All the specifications are subject to minor change without prior notice.

CAUTIONS

- The apparatus shall not be exposed to dripping or splashing and that no objects filled with liquids, such as vases, shall be placed on the apparatus.
- Turn off the Camera/Monitor if the system is not in use.
- The adapter is used as the disconnect device from the mains. The adapter shall remain readily operable.
- The Camera/Monitor can only be completely disconnected from the mains by unplug the adapter.
- Do not cut the DC power cable of the apparatus to fit with another power source.
- Attention should be drawn to the environment aspects of battery disposal.
- Remove the batteries when cleaning the unit.
- Remove the batteries before storing the unit for a long time.
- When necessary, REPLACE ALL FOUR BATTERIES in this unit with new ones.
- Use only the size and type of battery specified.
- Be sure to install the battery with the correct polarity as indicated in the battery compartment.
- Properly dispose of the battery. Exposure to high temperatures can cause the battery to explode, so do not dispose of in a fire. Place tape over the terminals to prevent direct contact with other objects. Some countries have regulations concerning battery disposal. Please follow all applicable regulations.

The graphics included are subject to minor change without notice.

FCC INFORMATION

This device complies with part 15 of the FCC Rules. Operation is subject to the following two conditions:

- (1) this device may not cause harmful interference,
- (2) this device must accept any interference received, including interference that may cause undesired operation.

Changes or modifications not expressly approved by the party responsible for compliance could void the user's authority to operate the equipment.

EU Environmental Protection

Waste electrical products should not be disposed of with household waste. Please recycle where facilities exist. Check with your Local Authority or retailer for recycling advice.

